

scénographie

nord

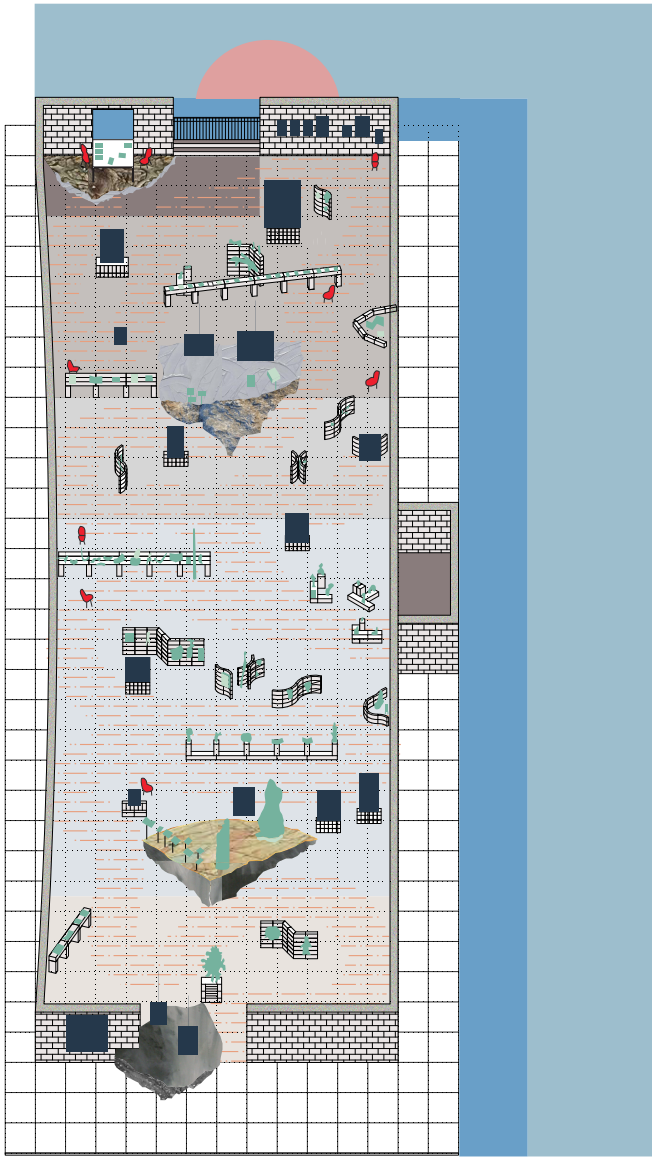

Dubuffet

Scénographie de l'exposition temporaire
«Dubuffet, un barbare en Europe»

- * Location/ Marseille (FR)
- * Date/ 2018
- * Client/ Mucem
- * Area/ 1200 m²
- * Budget/ 200.000 € HTVA
- * Statut/ Finalist - 3^{ème} place

*Collaboration avec Victoire Chancel et
Sophie Dars*





RESIST!

Scénographie Exposition Summer of Photography

- * Location/ Bruxelles (BE)
- * Date/ 2018
- * Client/ BOZAR
- * Area/ 1624 m²
- * Budget/ 40.000 € HTVA
- * Statut/ Finalist - 2^{ème} place

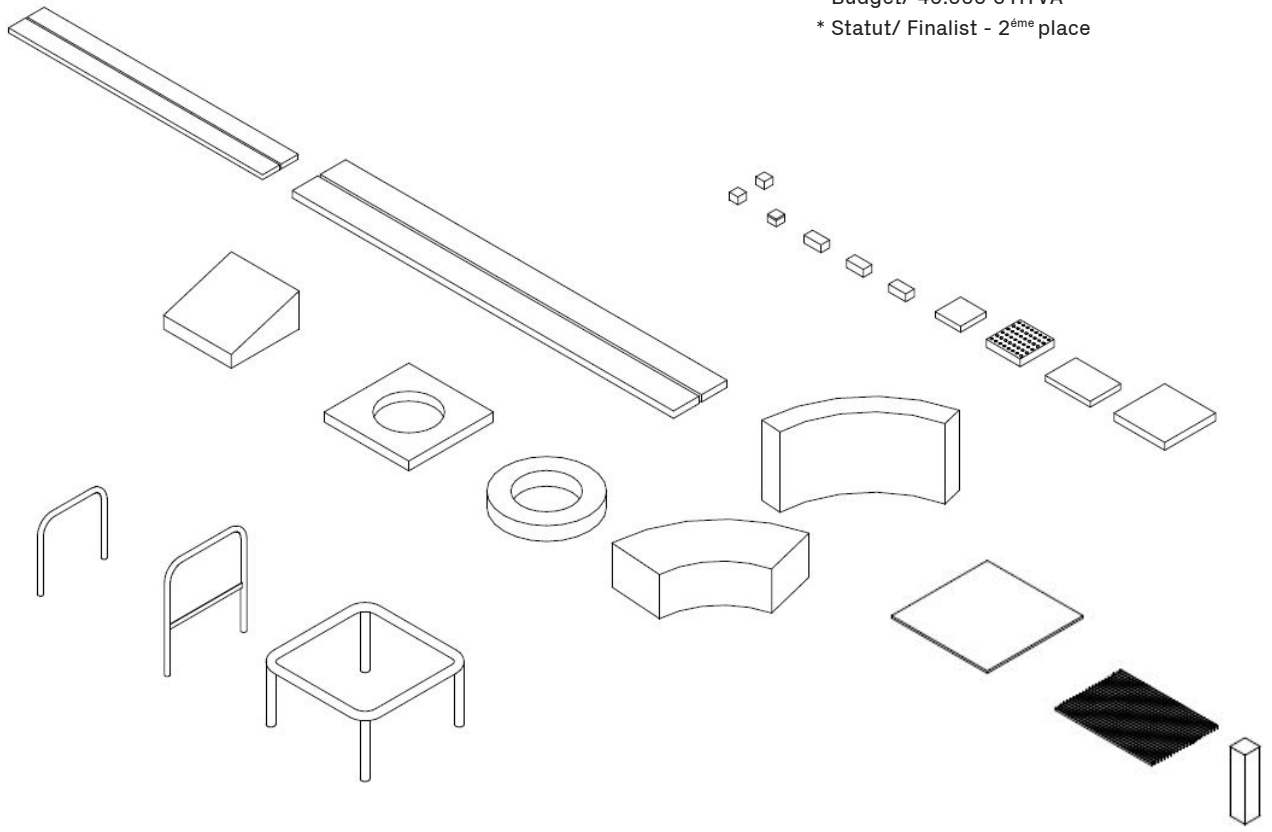

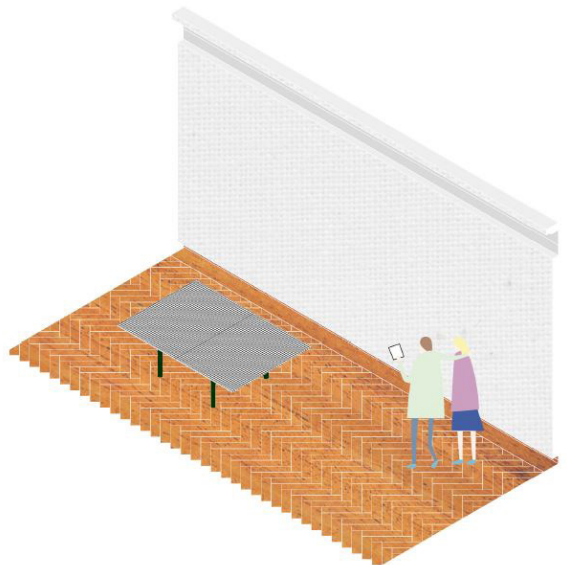
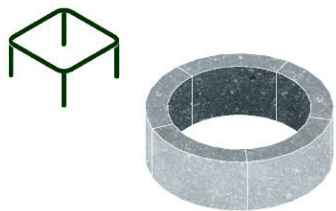
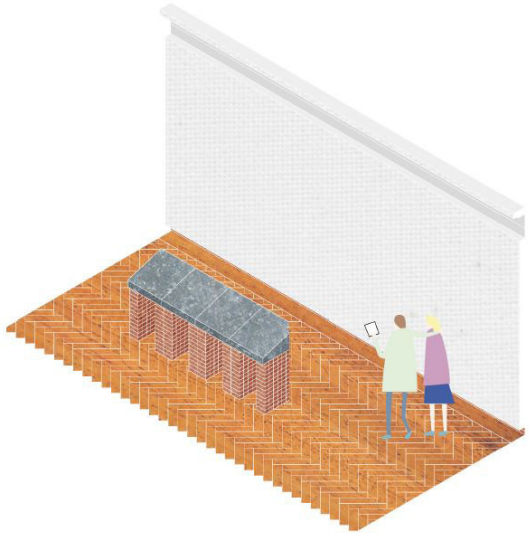
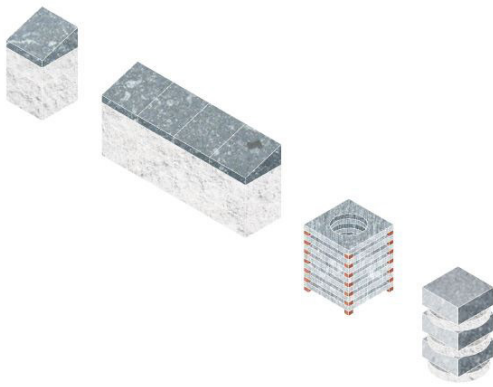
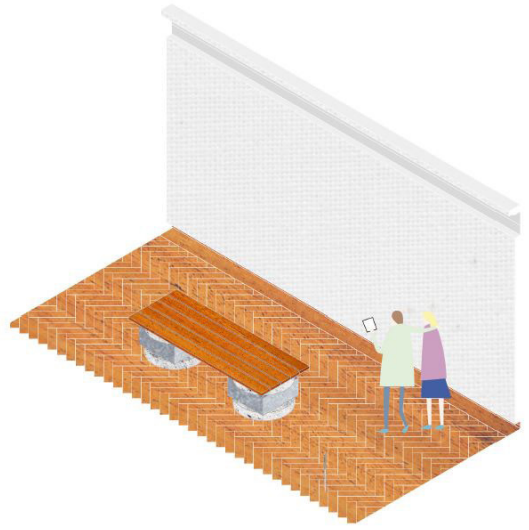
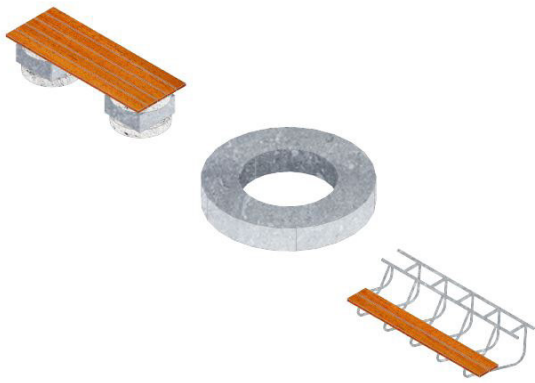

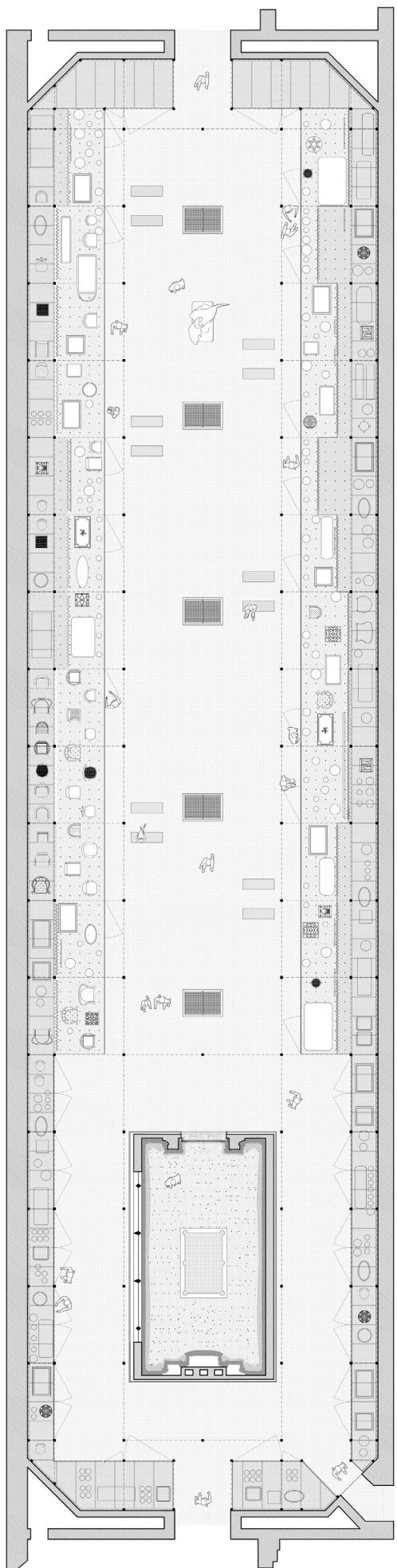

MRAH

Scénographie et aménagements intérieurs
de deux ailes historiques d'un musée pour
l'exposition permanente des collections
«arts décoratifs des XIX^e et XX^e siècles»

- * Location/ Bruxelles (BE)
- * Date/ 2017
- * Client/ Musées Royaux d'Art et d'Histoire
- * Area/ 1200 m²
- * Budget/ 1.750.000 € HTVA
- * Statut/ Finalist - Proposition non retenue

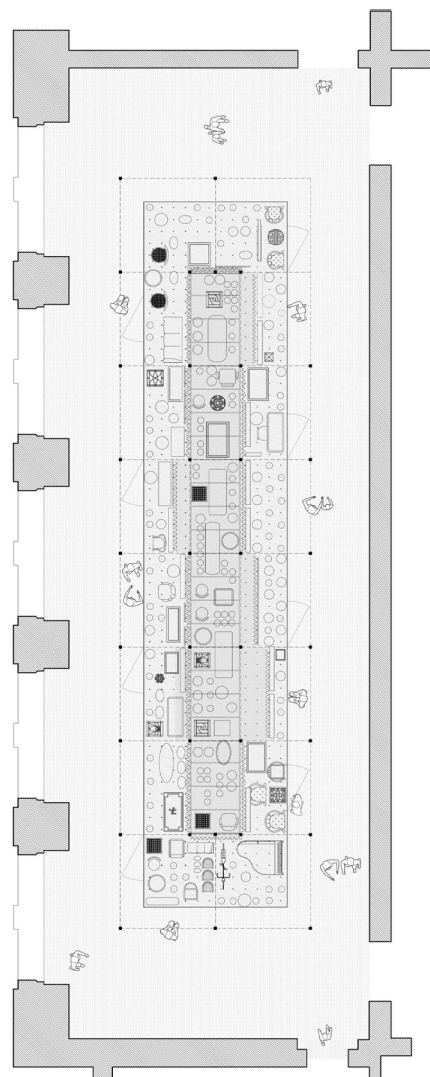



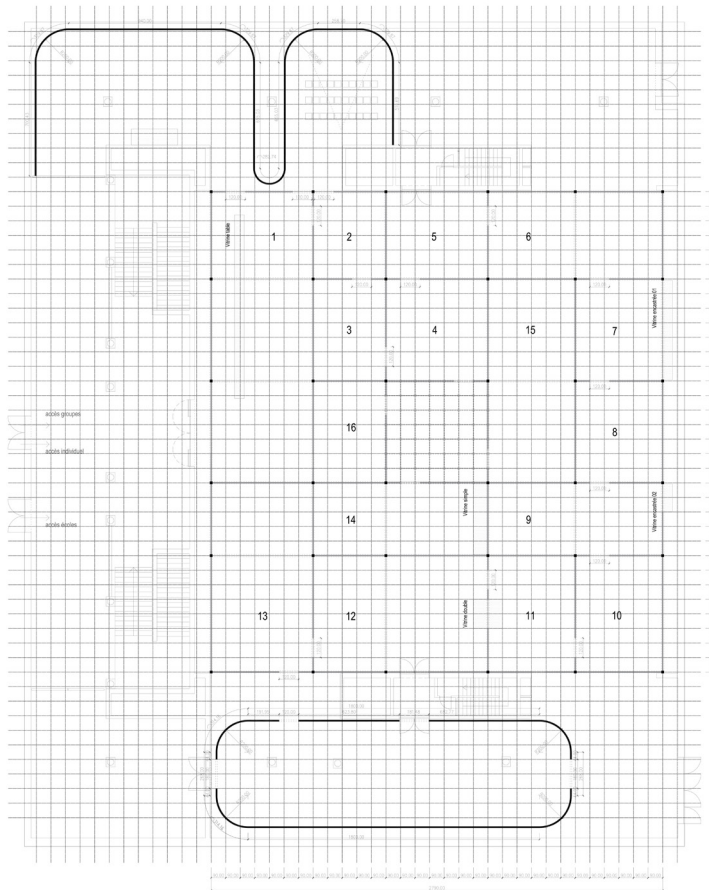

Ukiyo-e

Scénographie de l'exposition temporaire
«Ukiyo-e, les plus belles estampes japonaises»

- * Location/ Bruxelles (BE)
- * Date/ 2016
- * Client/ Musées Royaux d'Art et d'Histoire
- * Area/ 900m²
- * Budget/ 120.000 € HTVA
- * Statut/ Dossier d'exécution (procédure interrompue par le client)

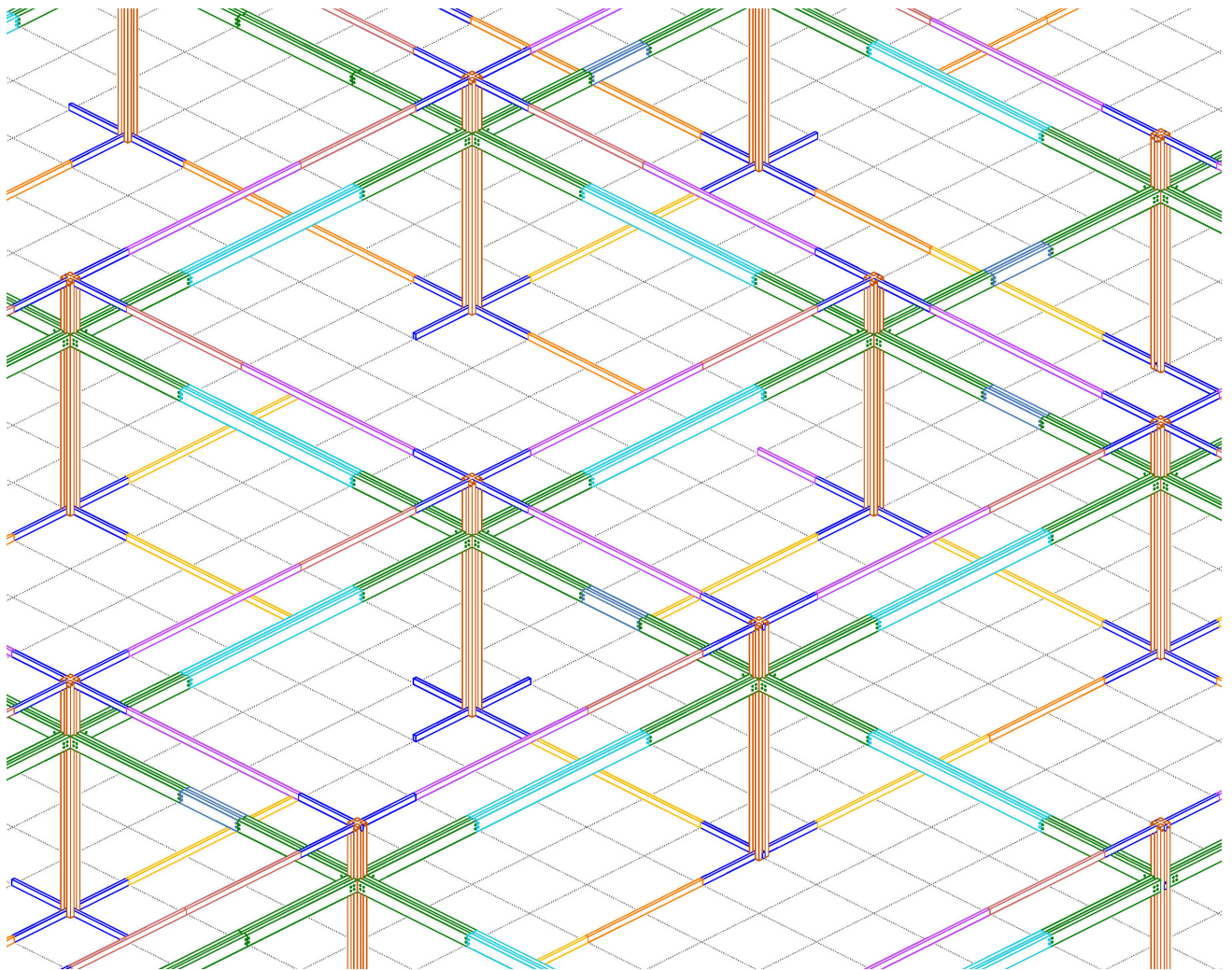

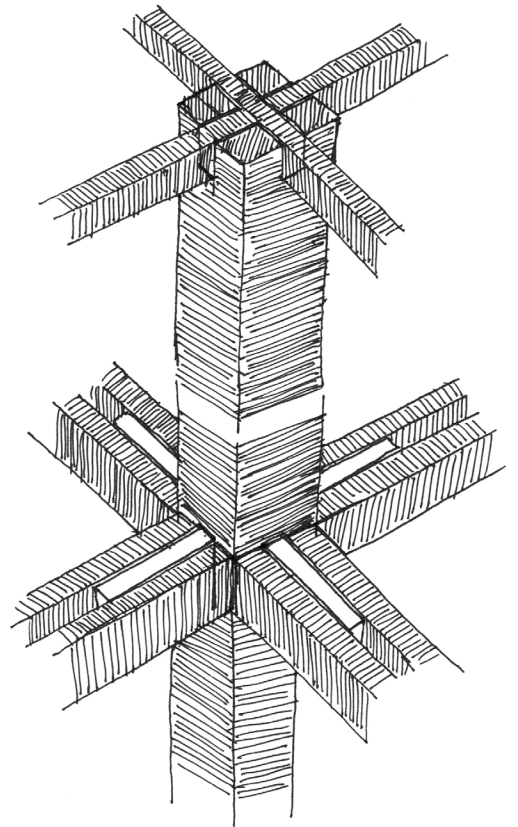
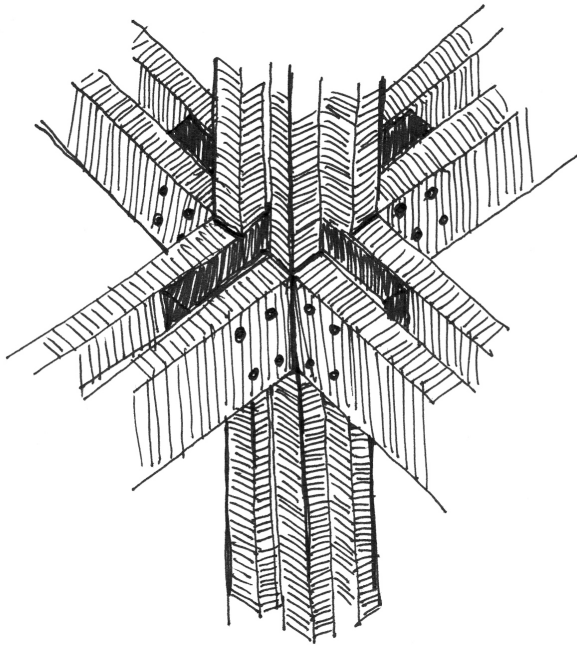
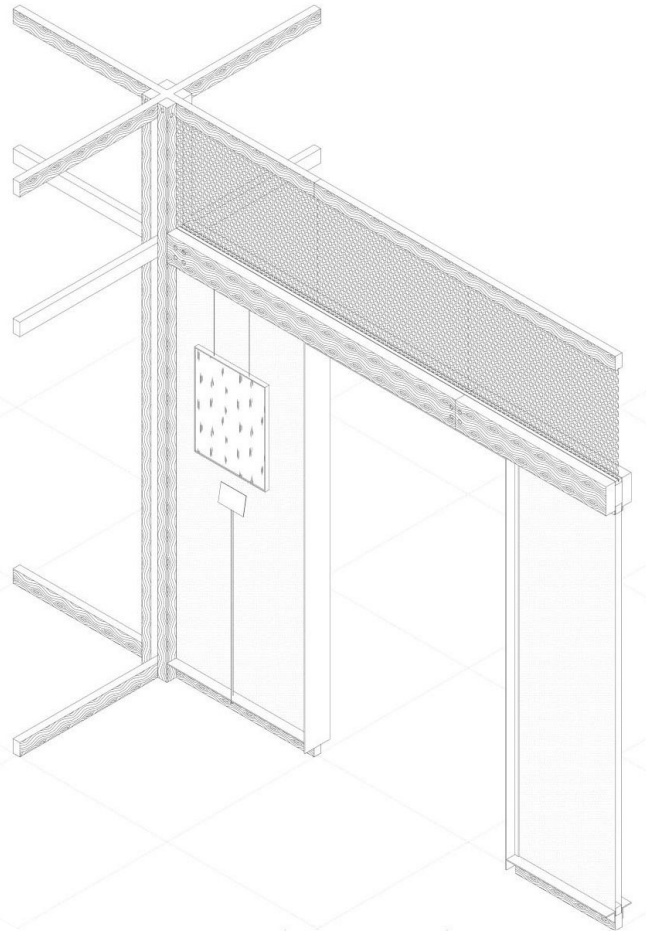
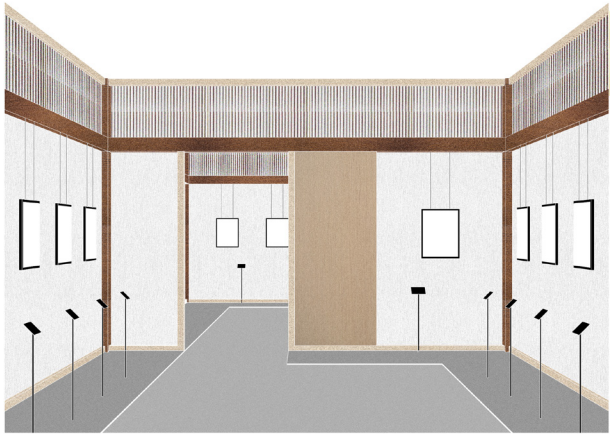

Losseau

Scénographie, muséographie, aménagements intérieurs d'un musée

*Location/ Mons (BE)

*Date/ 2015

*Client/ Province du Hainaut

*Area/ 364 m²

*Budget/ 592.087 € HTVA

*Statut/ Livré

Collaboration avec Label architecture



